

INSTALLATION INSTRUCTIONS

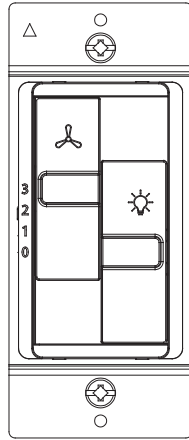

Model: LDFS-1P3S Combination LED Dimmer and 3 speed Fan Control

* Single-Pole Only

* Neutral NOT REQUIRED

SPECIFICATIONS

Voltage.....	120VAC, 60Hz
LED/CFL.....	200 Watts
Incandescent/ Halogen.....	360 Watts
Fan.....	2.5A
Wire Gauge.....	#18 ~ #12 AWG

WARNING

Turn the power off at the circuit breaker before installing this device.

Read and understand these instructions before installing. This device is intended for installation in accordance with the National Electric Code and local regulations. It is recommended that a qualified electrician performs this installation. Make sure to turn off the circuit breaker or fuse(s) and make sure power is off before wiring the device.

Use copper wire only. No Aluminum.

INPUT: Use wires with minimum rating of 75° C (167° F)

WARRANTY

This device is warranted to be free of material and workmanship defects for 1 year from the date of purchase. Original receipt or proof of purchase from an authorized retailer must be presented upon warranty claim. ALL claims must be verified and approved by Lider-Electric, Inc. Warranties from other Lider-Electric products may vary. This warranty is nontransferable and does not cover normal wear and tear or any malfunction, failure, or defect resulting from misuse, abuse, neglect, alteration, modification, or improper installation. To the fullest extent permitted by the applicable state law, Lider-Electric shall not be liable to the purchaser or end user customer of Lider-Electric products for direct, indirect, incidental, or consequential damages even if Lider-Electric has been advised of the possibility of such damages. Lider-Electric's total liability under this or any other warranty, express or implied, is limited to repair, replacement or refund. Repair, replacement or refund are the sole and exclusive remedies for breach of warranty or any other legal theory

WIRING DIRECTIONS

1. Remove the wall plate.
2. Remove existing switch from wall box and prior to disconnecting wires, identify the wires and label as needed.
3. Remove wires from existing switch.
4. Follow the diagram below to connect the LDFS-1P3S

LDFS-1P3S dimmer/fan speed control replaces standard on/off switches.

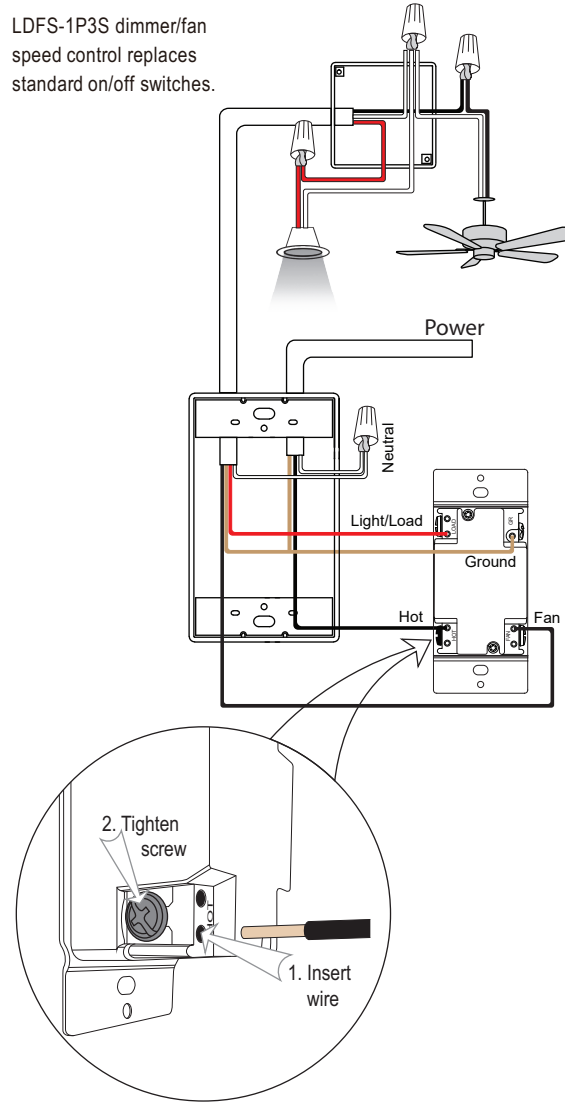

OPERATING INSTRUCTIONS

Before using this switch to control your fan, be sure to first set the speed on the ceiling fan to high. Some fan models may have a pull string attached to its side or underside. Please check the fan manufacturer's instructions on how to change fan speed.

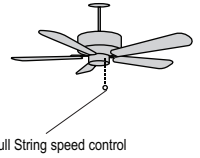

The dimming slider has an off position when you move the slider all the way down. There will be a noticeable click when you slide to turn on or off.

Be sure to use dimmable light bulbs!

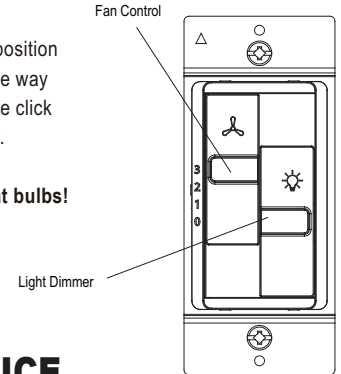

IMPORTANT NOTICE

This is a SINGLE-POLE SWITCH

You must have two load wires in the switch box and a HOT wire in order to use this switch. One load wire goes to the LIGHT and the other load wire goes to the FAN

