

# INSTALLATION INSTRUCTIONS

6 time selection buttons

6 LED indicator lights for selected times

ON/OFF Button with hold on function

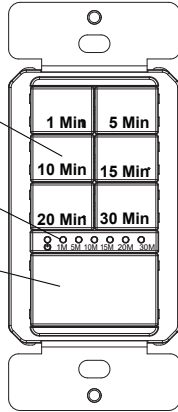

Model: LTS-30M-G

30 Min TIMER SWITCH  
GROUND REQUIRED

## FEATURES

- Six preset time buttons and one ON/OFF button
- LED indicator lights
- Time delay options: 1, 5, 10, 15, 20, and 30 minutes
- Replaces a standard switch for controlling lights or fans
- Ideal for use in closets, pantries, garages, laundry rooms, outdoor lighting, and bathrooms.

## SPECIFICATIONS

Voltage .....	120VAC, 60Hz
Tungsten .....	800W
Resistive .....	6.4A
Electronic Ballast .....	800VA
Flourescent .....	800VA
Motor .....	1/4HP
Time Delay .....	1, 5, 10, 15, 20, 30 minutes
Humidity .....	95% RH, non-condensing
Operation Temperature .....	32° F--131° F (0° to 55° C)

## WARNING

### Turn the power off at the circuit breaker before installing

Read and understand these instructions before installing. This device is intended for installation in accordance with the National Electric Code and local regulations. It is recommended that a qualified electrician performs this installation. Make sure to turn off the circuit breaker or fuse(s) and make sure power is off before wiring the device.

Use copper wire only.

## WARRANTY

This device is warranted to be free of material and workmanship defects for 1 year from the date of purchase. Original receipt or proof of purchase from an authorized retailer must be presented upon warranty claim. ALL claims must be verified and approved by Lider-Electric, Inc. Warranties from other Lider-Electric products may vary. This warranty is nontransferable and does not cover normal wear and tear or any malfunction, failure, or defect resulting from misuse, abuse, neglect, alteration, modification, or improper installation. To the fullest extent permitted by the applicable state law, Lider-Electric shall not be liable to the purchaser or end user customer of Lider-Electric products for direct, indirect, incidental, or consequential damages even if Lider-Electric has been advised of the possibility of such damages. Lider-Electric's total liability under this or any other warranty, express or implied, is limited to repair, replacement or refund. Repair, replacement or refund are the sole and exclusive remedies for breach of warranty or any other legal theory

## REQUIREMENTS

For your safety: Connecting a proper ground to the timer switch provides protection against electrical shock. If a proper ground is not available, it is recommended to consult with a qualified electrician before proceeding with the installation.

## WIRING DIRECTIONS

1. Turn OFF power at the circuit breaker or fuse
2. Remove the wall plate
3. Remove existing switch from wall box and prior to disconnecting wire identify the wires and label as needed.
4. Remove wires from existing switch
5. Follow the diagram below to reconnect the timer switch
6. Turn ON the power at the circuit breaker

**Note:** When powering on for the first time, there will be a delay. After each power reset, such as a power outage, there is a 60-second warm-up period.

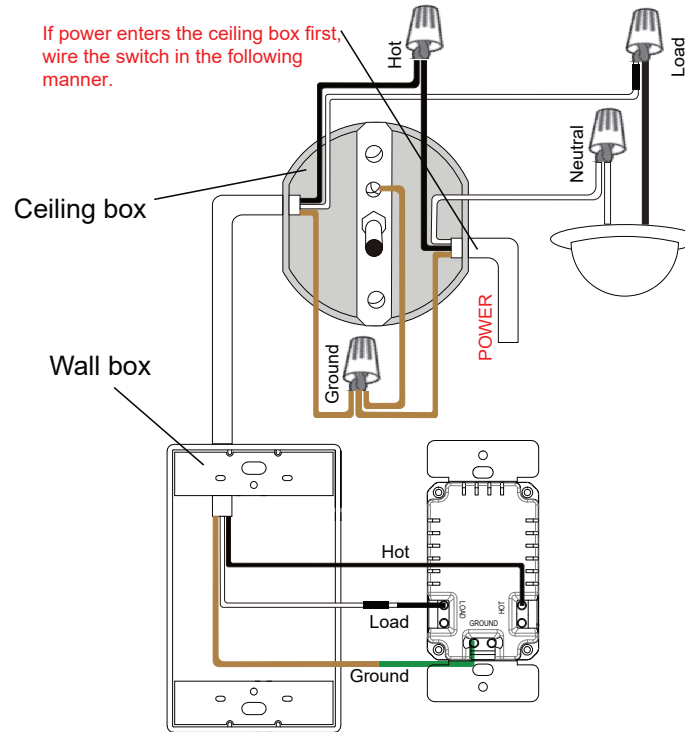

If power enters the wall first, wire the switch in the following manner.

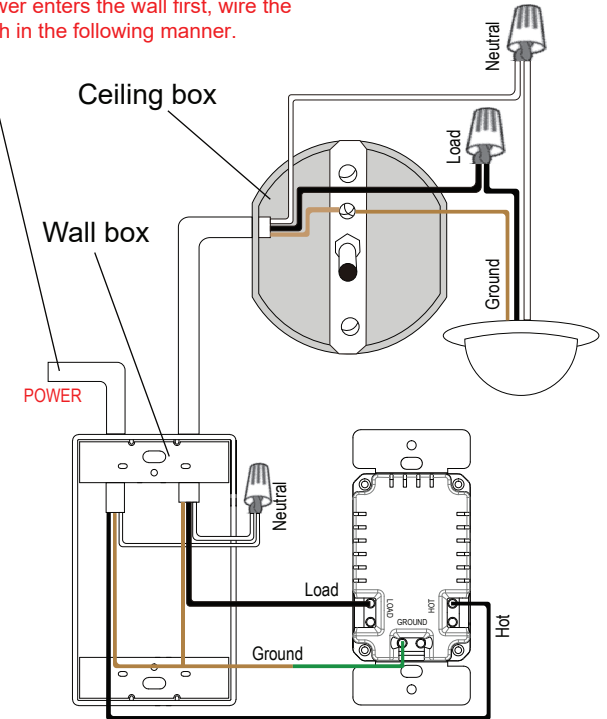

## OPERATION AND LED INDICATORS

- The LTS-30M-G is a timer switch that turns ON the connected light or fan (LOAD) when the desired time button is pushed. Once the selected time expires, the switch will turn the LOAD OFF.
- The available time selections are 1min, 5min, 10min, 15min, 20min, 30min
- To add more time while the timer is in the "ON" state, simply press and release the desired time button, the LED indicate that the timer has restarted with the selected amount of time.

### LED Indicators Mode:

- The Power LED indicator is on when the load is running.
- The associated LED will also be on when you make a time selection.
- The associated LED will be change as time selection decreases.

### Manual ON/ OFF Switch

- The large power button at the bottom of the switch is a manual on/off switch
- While in the "OFF" state, pushing the power button once and releasing it immediately will turn the load "ON" with the last used timer.
  - While in the "ON" state, pushing the power button once and releasing it immediately will turn the load "OFF"
  - Holding down the ON/OFF button for about 8 seconds will override the countdown and keep the load ON until the button is pressed again to turn it OFF.

